



# A-2128/A-2128S/A-2248S MIXER POWER AMPLIFIERS



Single or dual channel controllers  
ideal for delivery of speech and music

## A-2128, A-2128S & A-2248S Mixer Power Amplifiers

With options of 1-channel or 2-channel, these PA amplifiers meet the audio requirements for various sites. They have the possibilities to combine various systems, giving you the ideal solution especially for speech and music, in house of worship, multi-purpose halls, and schools.

## FEATURES

- Durable and multifunction
- 5 microphone inputs, 3 AUX inputs
- Mic 1 input is equipped with Echo and Phantom Power
- Individual volume control for each inputs
- Individual control for bass treble adjustment on each input
- Output speaker with 100V line and low impedance 4Ω
- AC/DC compliant
- Current limiter to prevent damage due to current overload
- Excess heat limit to protect the transistor and power transformer

## CONNECTION EXAMPLES

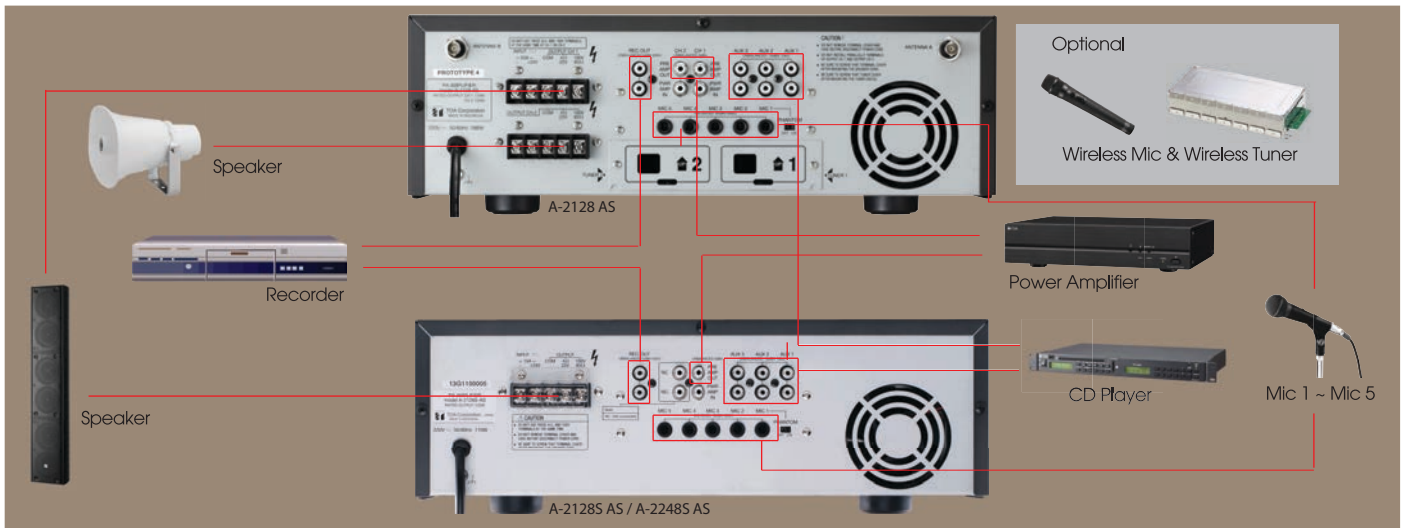

## SPECIFICATIONS

	A-2128 AS	A-2128S AS	A-2248S AS
Power Source	220V AC, 50/60 Hz or 24V DC		
Rated Output Power	2 x 120W	120W	240W
Power Consumption	520W (Operated with AC at rated output) 286W (Operated with AC at EN60065 standard) 20A (Operated with DC at rated output)	350W (Operated with AC at rated output) 170W (Operated with AC at EN60065 standard) 15A (Operated with DC at rated output)	600W (Operated with AC at rated output) 330W (Operated with AC at EN60065 standard) 20A (Operated with DC at rated output)
Frequency Response	50 - 20,000 Hz, ±3 dB		
Distortion	Less than 1% at 1kHz, 1/3 rated power		
Input	MIC 1: -60dB*, 600Ω, Balanced, Phone Jack, Echo MIC 2 - 3: -60dB*, 600Ω, Balanced, Phone Jack, WirelessTuner MIC 4 - 5: -60dB*, 600Ω, Balanced, Phone Jack AUX 1 - 3: -10dB*, 10kΩ, Unbalanced, RCA Pin Jack PWR AMP IN: 2 x 0db*, 10kΩ, Unbalanced, RCA Pin Jack	MIC 1: -60dB*, 600Ω, Balanced, Phone Jack, Echo MIC 2 - 5: -60dB*, 600Ω, Balanced, Phone Jack  AUX 1 - 3: -10dB*, 10kΩ, Unbalanced, RCA Pin Jack PWR AMP IN: 2 x 0db*, 10kΩ, Unbalanced, RCA Pin Jack	MIC 1: -60dB*, 600Ω, Balanced, Phone Jack, Echo MIC 2 - 5: -60dB*, 600Ω, Balanced, Phone Jack  AUX 1 - 3: -10dB*, 10kΩ, Unbalanced, RCA Pin Jack PWR AMP IN: 2 x 0db*, 10kΩ, Unbalanced, RCA Pin Jack
Output	High Impedance (83Ω): 2 x 100V Low Impedance (4Ω): 2 x 22V REC OUT: 0db*, 600Ω, Unbalanced, RCA Pin Jack PRE AMP OUT: 2 x 0db*, 600Ω, Unbalanced, RCA Pin Jack	High Impedance (83Ω): 100V Low Impedance (4Ω): 22V REC OUT: 0db*, 600Ω, Unbalanced, RCA Pin Jack PRE AMP OUT: 0db*, 600Ω, Unbalanced, RCA Pin Jack	High Impedance (42Ω): 100V Low Impedance (4Ω): 31V REC OUT: 0db*, 600Ω, Unbalanced, RCA Pin Jack PRE AMP OUT: 0db*, 600Ω, Unbalanced, RCA Pin Jack
Phantom Power	ON or OFF for Mic 1 with switch setting (+21V DC)		
S/N Ratio	More than 80db all minimum volumn control More than 50db all minimum volumn control		
Tone Control	Bass: ±10dB at 100Hz Treble: ±10dB at 10kHz		
LED Indicator	Power, Signal, Peak, Wireless Mic	Power, Signal, Peak, Wireless Mic	
Finish	Case: Steel Plate - Grey, Panel: Aliminum - Grey		
Dimensions	420 (W) x 144 (H) x 361 (D) mm		
Weight	19.5kg	13kg	14.5kg
Accessories	2 x BNC Antenna	N.A	N.A

\*0dB = 1.0V



Human Society with  
Sound & Communication

TOA Electronics Pte Ltd

www.toa.com.sg

Specifications are subject to change without notice.  
Printed in Singapore (65) 865-1213-01A